

AJMAN PEARL TOWER

SERIES 4

Size

2 BHK

Gross Area

2886.98 sq.ft.

268.21 sqm.

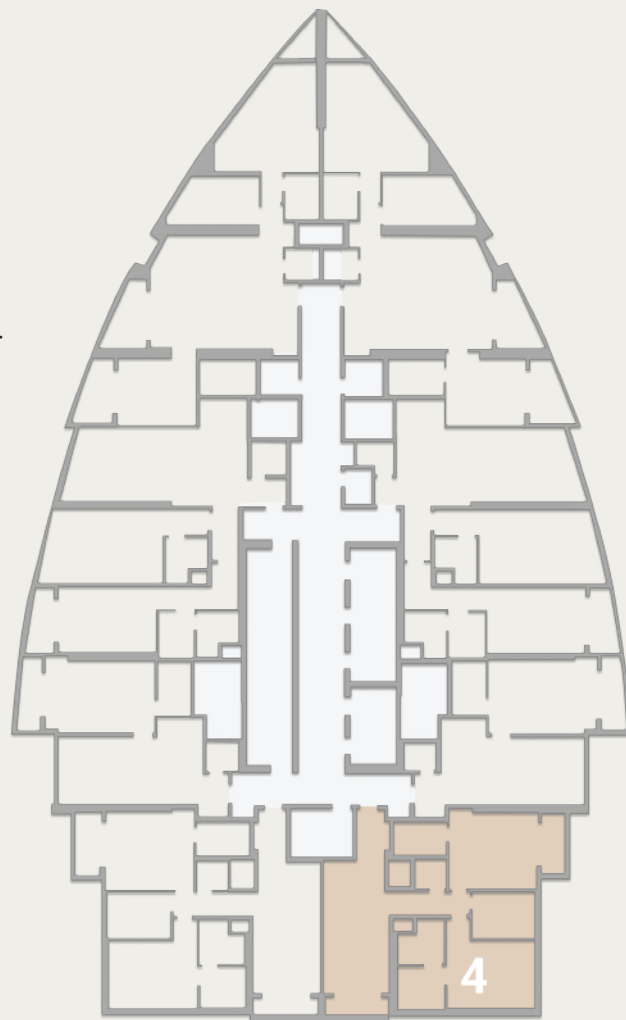

Disclaimer:

1. All materials, finishes, dimensions and drawings are approximate.
2. Actual suite area may vary from the stated area.
3. Drawings are not to scale.
4. Information is subject to change without notice.
5. The Developer reserves the right to make revisions/alterations without any liability whatsoever.